



TNT Manufacturing LLC

Food Process Equipment Sales, Engineering & Service

908 Harvard Drive
Sun Prairie, WI 53590
tntmanufacturing@charter.net
www.tntmanufacturing.biz

(414) 870-2422 Sales & Service
(608) 669-4720 Administrative
(608) 318-0981 Fax

WATERLESS **PEELER/SCRUBBER**



*U.S. Patent #'s
5,106,641 & 5,329,845

Cleans Without Water

PEELS

- Potatoes
- Carrots
- Onions

SCRUBS

- Potatoes after steam
- Tomatoes with pre-treatment
- Beets after steam
- Corn for chips and tortillas

- ***Improves Yield***
by brushing the Peel Away
- ***Reduces Water***
& Water Treatment Costs

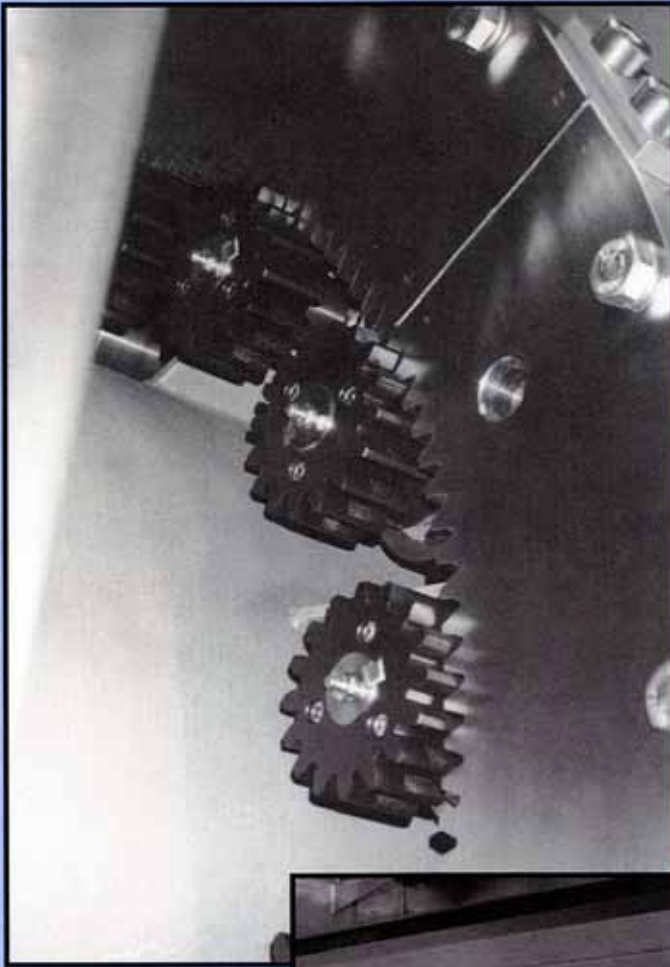

DRIVE END

Power is supplied through a system of planetary gears. Each brush has an individual pinion gear running inside a ring gear. This Planetary Gear System includes lubricant impregnated gears, so no additional lubrication is required.

Available with stainless steel or nonmetallic ring gear.

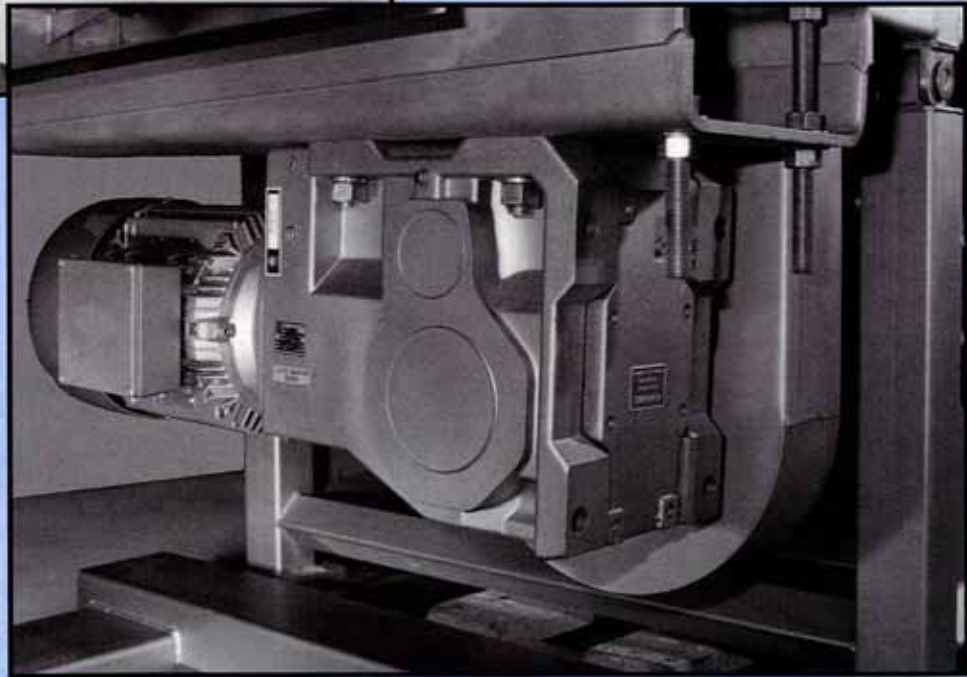

A gear type drive motor is used and drives the cage of rolls using a cog belt. A single speed gear drive is included and an AC inverter must be used.

QUICK CHANGE BRUSHES

Brushes are quickly and easily changed by the use of a single socket wrench. After removing two nuts from the discharge bearing and removing the bearing, the brush is easily slid forward and removed.

The process is repeated as required. Easy access doors provide for fast access to the brushes for cleaning and removal.



Stainless steel cartridge bearings with stainless steel ball bearings are standard.



OPTIONAL ACCESSORIES

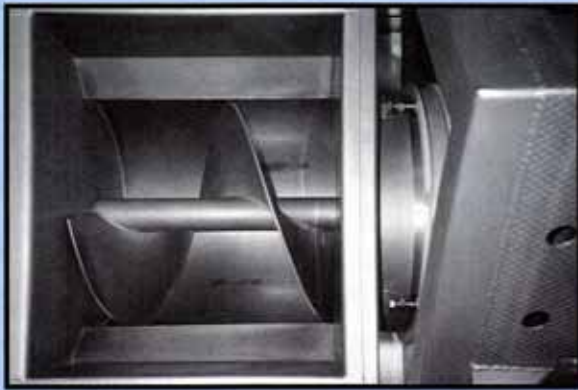

AUGER INFEED

The auger infeed is used in high capacity applications to move the product rapidly into the peeler.

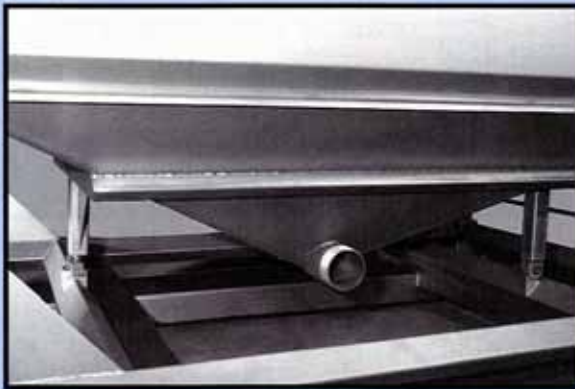

WASTE PAN

Waste pans are available in several different configurations based upon the application. Load cells for automatic pump control of the peel waste are also available.



LUBERATOR

An automatic lubricating system lubricates the two main ring bearings whenever the machine is in operation.



DISCHARGE END

The discharge end of the unit is shown at the left.

Product retention time in the unit is adjusted by the screw jacks shown under the front legs. A simple hand crank adjusts the pitch of the machine to achieve the desired retention time.

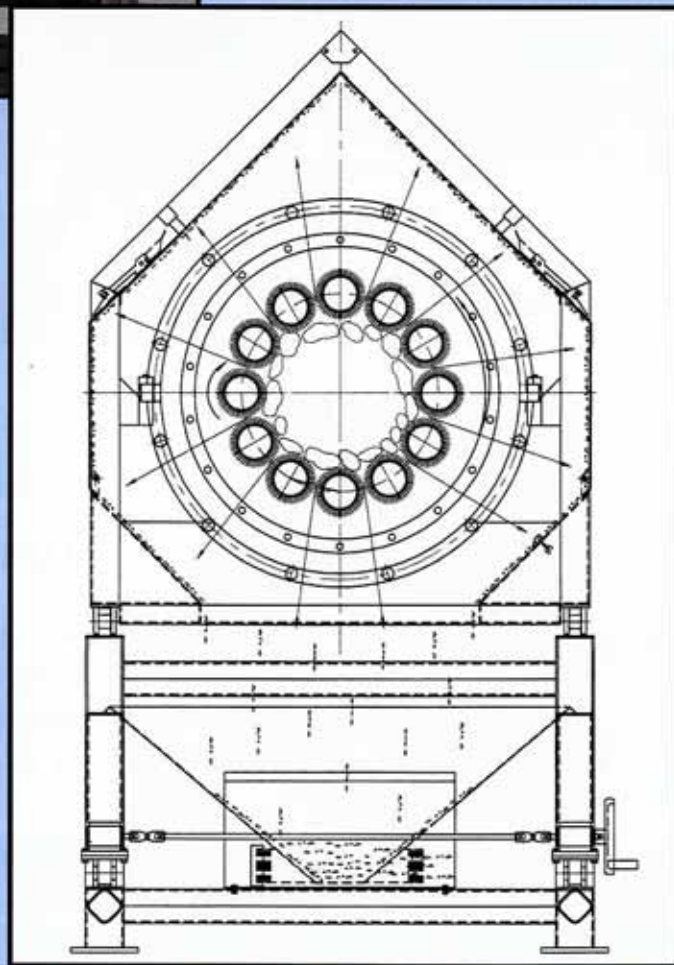

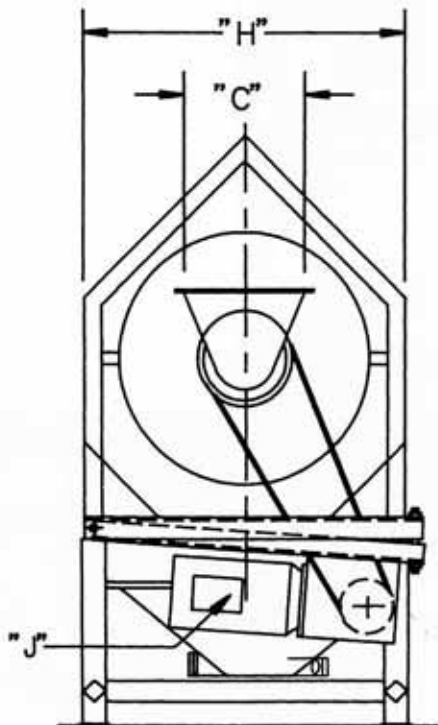
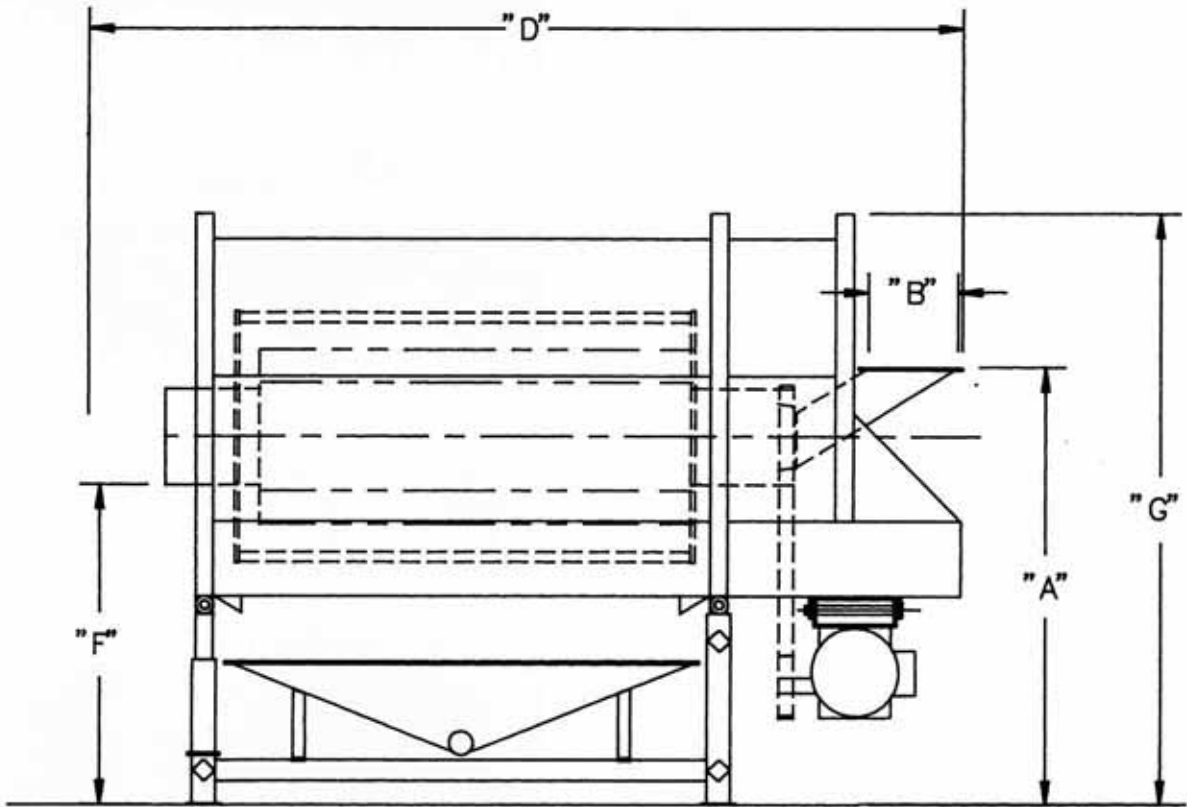

SPECIFICATIONS:

	RC-8L	RC-12L	RC-16L
INLET HEIGHT (A)	64"	75"	77"
INLET LENGTH (B)	13"	14"	18"
INLET WIDTH (C)	18"	18"	24"
TOTAL LENGTH (D)	88"	122"	122"
DISCHARGE HT. (F)	36"	42"	39"
OVER-ALL HT. (G)	67"	95"	95"
FRAME WIDTH (H)	36"	52"	52"
DRIVE H.P. (J)	10	20	30

NOTE: Some Optional Items Not Shown.